

2600 series

Power rocker switches

Distinctive features and specifications

UG1410A



- Three rocker shapes : plain, V-shaped or concave
- Various rocker colours
- Frame with protection guard on 2600LP models
- Illuminated or non-illuminated
- UL, CSA, VDE and NF (EN 61058-1) approved

ELECTRICAL SPECIFICATIONS

- Max. current/voltage rating with resistive load and approved ratings : see table below.
- Initial contact resistance : 10mΩ max.
- Insulation resistance : 1.000 MΩ min. at 500VDC
- Dielectric strength : 2.500 Vrms 50 Hz min. between terminals
3.000 Vrms 50 Hz min. between terminals and metal panel
- Electrical life : 10.000 cycles at full load

| FUNCTIONS | APPROVED RATINGS | | | | DIRECT CURRENT | |
|---------------------|--|--|----------------------------|----------------------------|----------------|--------|
| | CSA (double pole) | UL (double pole) | VDE | NF | 24 VDC | 12 VDC |
| | CSA 22-2 | UL 1054 | EN 61058-1 | EN 61058-1 | | |
| ON - OFF ON - ON | 1/6 HP 125VAC 16A 125VAC 16A 250VAC 1/3 HP 250VAC | 1/6 HP 125VAC 16A 125VAC 16A 250VAC 1/3 HP 250VAC | 10(4)A 250VAC T 85/55 | - | 10A | 15A |
| ON - OFF - ON | 10A 125VAC 10A 250VAC 1/6 HP 125/250VAC | 10A 125VAC 10A 250VAC 1/6 HP 125/250VAC | L1 option 10(4)A 250VAC | L1 option 10(4)A 250VAC | 8A | 10A |
| ON - ON - ON | - | - | - | - | 5A | 8A |
| OTHERS | 10A 125VAC 10A 250VAC 1/6 HP 250VAC | - | L1 option 10(4)A 250VAC | L1 option 10(4)A 250VAC | 8A | 10A |

MATERIALS

- Case : melamine/polyester
- Frame : polyamide
- Actuator : polyamide
- Contacts :
- A : silver
- C : copper, silver plated

GENERAL SPECIFICATIONS

- Panel thickness : 0,8 mm to 4 mm (.031 to .157)
- Operating temperature :
 - silver contacts (A) : -20°C to +85°C
 - silver plated contacts (C) : -10°C to +55°C

AGENCY APPROVALS



EN 61058-1 EN 61058-1

Availability : consult factory for details of approved models.

Marking : approved models are standard marked.

The company reserves the right to change specifications without notice.

2600 series

Power rocker switches

Overview

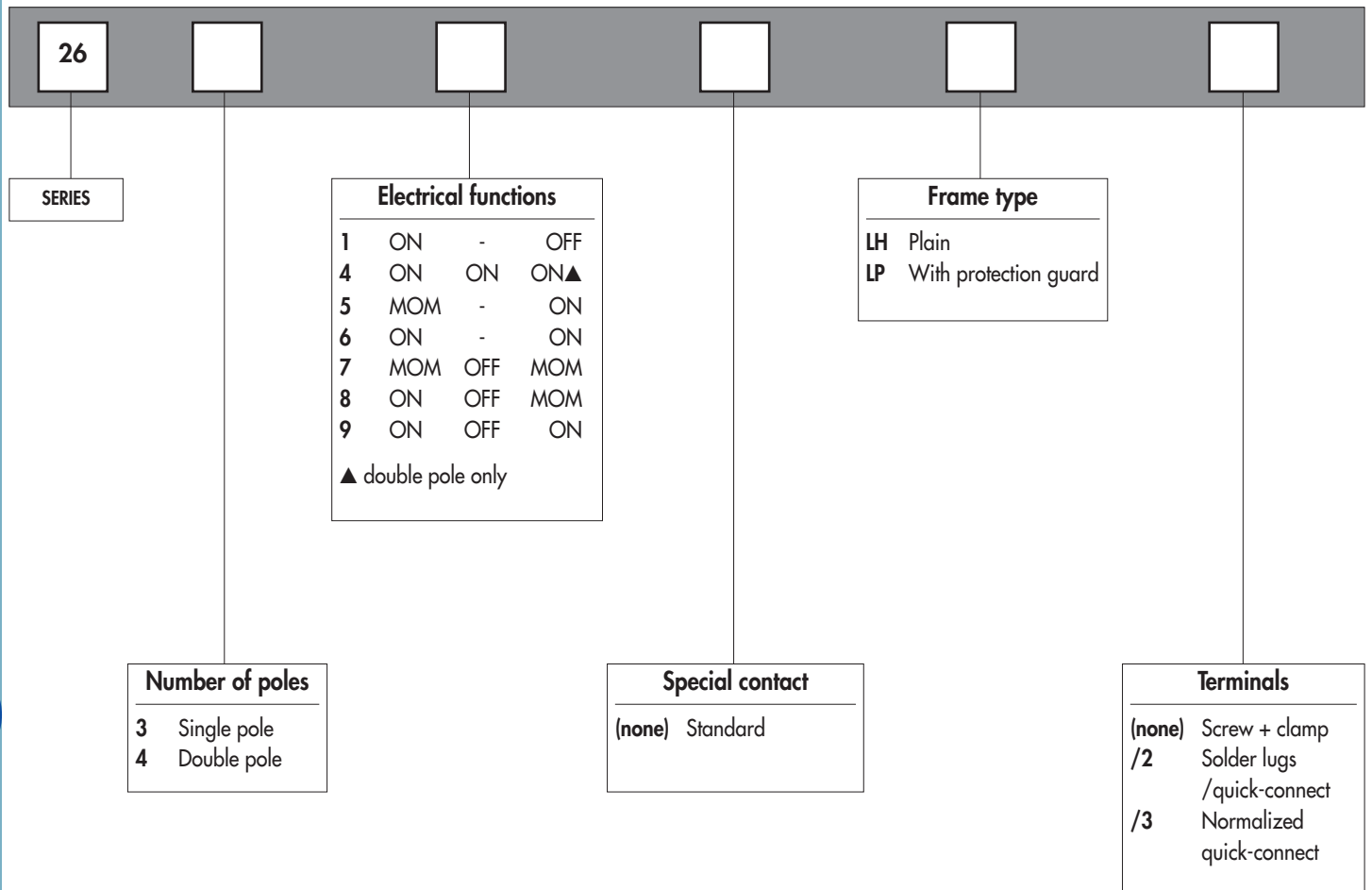

ABOUT THIS SERIES

On the following pages, you will find successively :

- model structure of switches
- options in the same order as in above chart

Dimensions : first dimensions are in mm while inches are shown as bracketed numbers.



Sealing boot U21 50 available to protect the switches against dust and water. See section H.



NOTICE : please note that not all combinations of above numbers are available. Refer to the following pages for further information.



2600 series

Power rocker switches

Overview

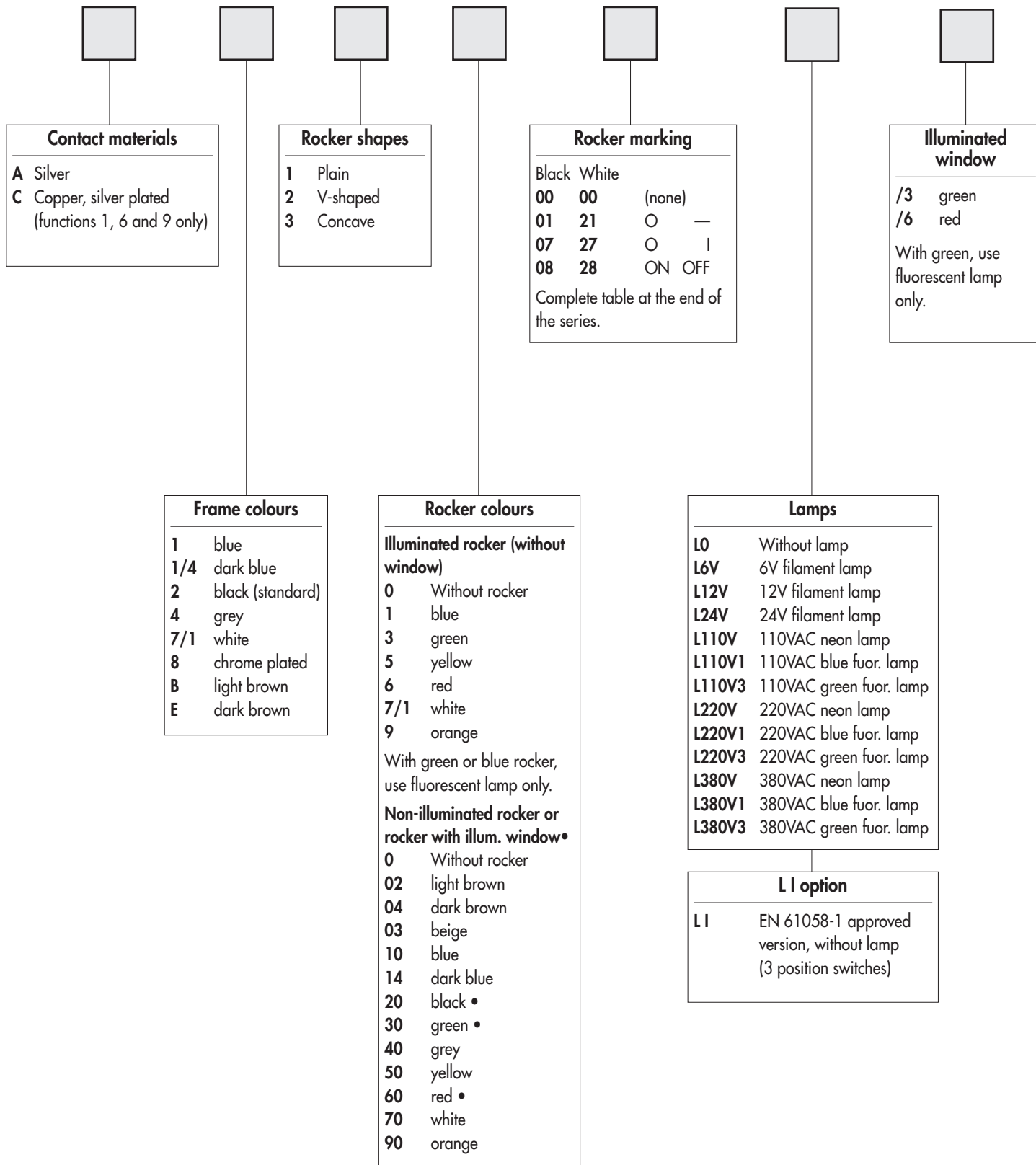

Packaging unit : 20 pieces per type and colour.

2600 series

Power rocker switches

MODEL
STRUCTURE

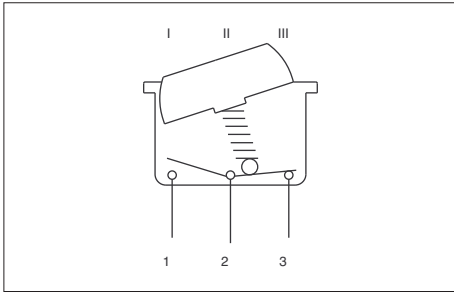

- Model 2600LP with protection guard
- 1 and 2 pole configurations

2640LH

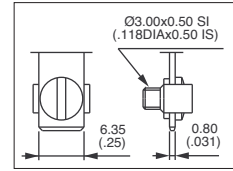

2640LH/2

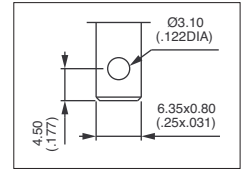

MODEL
STRUCTURE



2600LH - single pole



Screw term.
+ clamp

Solder lug/
quick-connect

III II I
A2-A1 A2-A3

| | | |
|-----|-----|-----|
| ON | - | OFF |
| MOM | - | ON |
| ON | - | ON |
| MOM | OFF | MOM |
| ON | OFF | MOM |
| ON | OFF | ON |

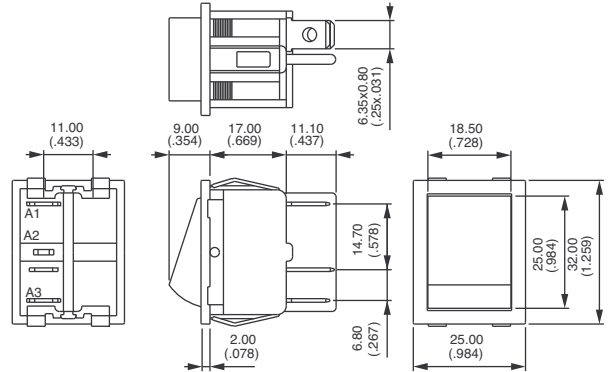

2600LH - double pole



Screw term.
+ clamp

Solder lug/
quick-connect

III II I
A2-A1 A2-A3
B5-B4 B5-B6

| | | |
|-----|-----|-----|
| ON | - | OFF |
| ON | ON | ON |
| MOM | - | ON |
| ON | - | ON |
| MOM | OFF | MOM |
| ON | OFF | MOM |
| ON | OFF | ON |

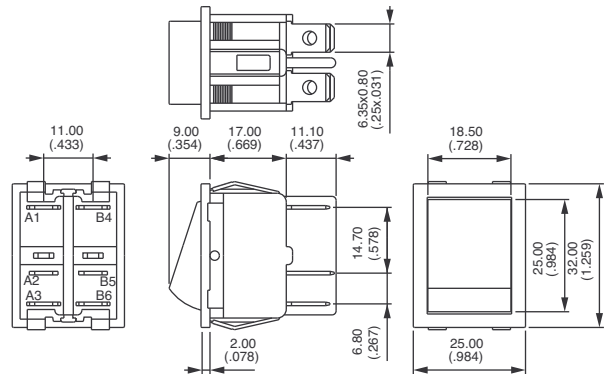

* Function 4 : SP in DP case, see end of catalogue.

2600LP - with protection guard - single pole



Screw term.
+ clamp

Solder lug/
quick-connect

III II I
A2-A1 A2-A3

| | | |
|-----|-----|-----|
| ON | - | OFF |
| MOM | - | ON |
| ON | - | ON |
| MOM | OFF | MOM |
| ON | OFF | MOM |
| ON | OFF | ON |

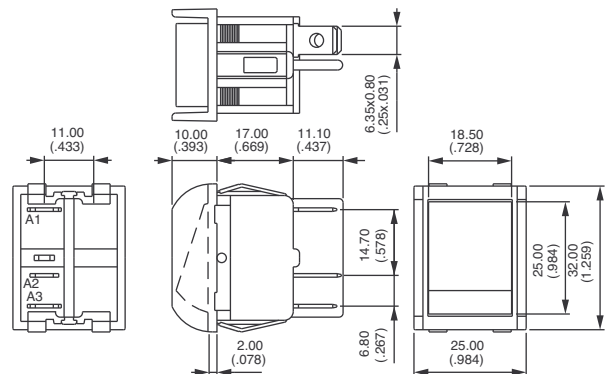



2600 series

Power rocker switches

2600LP - with protection guard - double pole



| | III | II | I |
|------------------------------|------------------|-------------|---|
| | A2-A1 | A2-A3 | |
| | B5-B4 | B5-B6 | |
| Screw term. + clamp | | | |
| Solder lug/ quick-connect | | | |
| 2641LP | 2641LP/2 | ON - OFF | |
| 2644LP* | 2644LP/2* | ON ON ON | |
| 2645LP | 2645LP/2 | MOM - ON | |
| 2646LP | 2646LP/2 | ON - ON | |
| 2647LP | 2647LP/2 | MOM OFF MOM | |
| 2648LP | 2648LP/2 | ON OFF MOM | |
| 2649LP | 2649LP/2 | ON OFF ON | |

* Function 4 : SP in DP case, see end of catalogue.

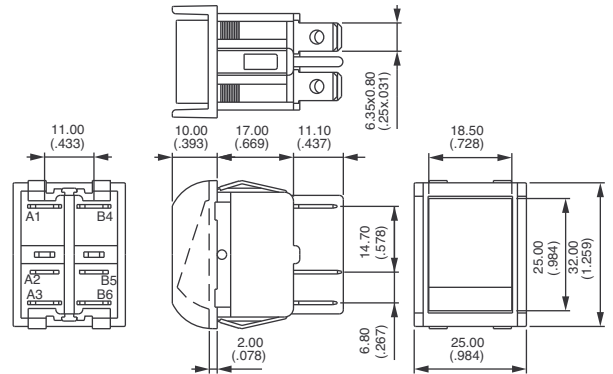

PANEL CUT-OUT

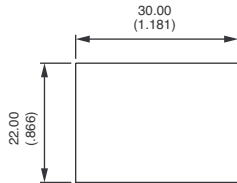

TERMINAL OPTION

Specify after LH or LP.

/3 Normalized quick-connect terminals 6,35 x 0,8 (.250 x .031)

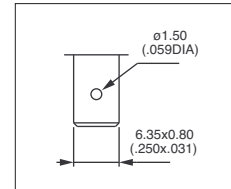

2600 series

Power rocker switches

OPTIONS



CONTACT MATERIALS

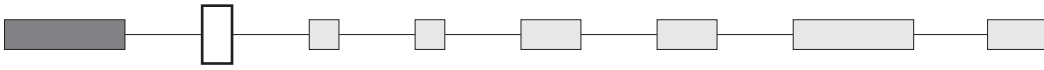

- A Silver
- C Copper, silver plated (available with functions 1, 6 and 9 only)

FRAME COLOURS

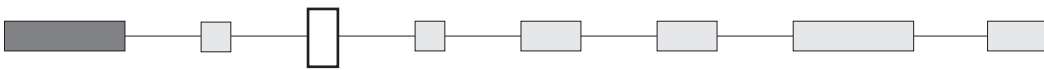

- 1 Blue
- 1/4 Dark blue
- 2 Black (standard)
- 4 Grey
- 7/1 White
- 8 Chrome plated
- B Light brown
- E Dark brown



This option has UL approval only.

ROCKER SHAPES

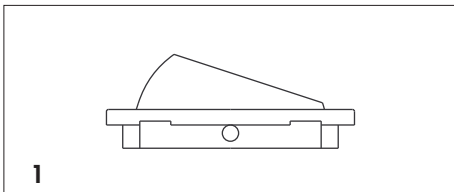
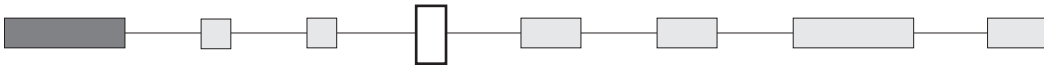

1

Plain

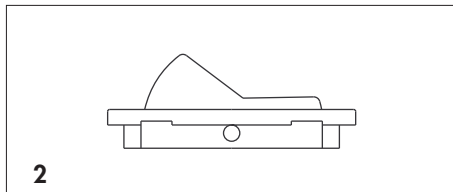

2

V-shaped

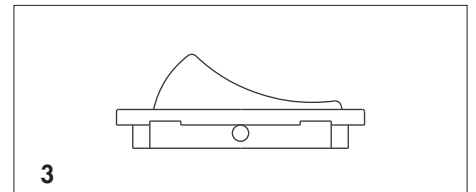

3

Concave



2600 series

Power rocker switches

ROCKER COLOURS

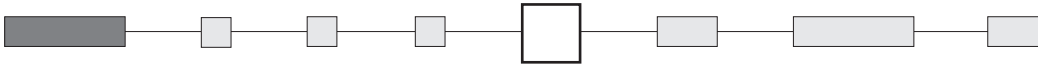

For illuminated switches

| | Without rocker | Blue* | Green* | Yellow | Red | White | Orange |
|---------------------|----------------|----------|----------|----------|----------|------------|----------|
| Plain rocker P/N | - | U881 | U883 | U885 | U886 | U887 | U889 |
| V-shaped rocker P/N | - | U861 | U863 | U865 | U866 | U867 | U869 |
| Concave rocker P/N | - | U871 | U873 | U875 | U876 | U877 | U879 |
| Colour code | 0 | 1 | 3 | 5 | 6 | 7/1 | 9 |

* With green or blue rocker, use fluorescent lamp only.

For non-illuminated switches or switches with illuminated window (•)

| | Without rocker | Light brown | Dark brown | Beige | Blue | Dark blue | Black | Green | Grey | Yellow | Red | White | Orange |
|---------------------|----------------|-------------|------------|-----------|-----------|-----------|------------|------------|-----------|-----------|------------|-----------|-----------|
| Plain rocker P/N | - | U1250B | U1250BF | U1250 | U1251 | U1251/4 | U1252 | U1253 | U1254 | U1255 | U1256 | U1257 | U1259 |
| V-shaped rocker P/N | - | U1270B | U1270BF | U1270 | U1271 | U1271/4 | U1272 | U1273 | U1274 | U1275 | U1276 | U1277 | U1279 |
| Concave rocker P/N | - | U1260B | U1260BF | U1260 | U1261 | U1261/4 | U1262 | U1263 | U1264 | U1265 | U1266 | U1267 | U1269 |
| Colour code | 0 | 02 | 04 | 03 | 10 | 14 | 20• | 30• | 40 | 50 | 60• | 70 | 90 |

Complete box with one of above colour codes.

To order rockers separately, use their P/N (U....) and complete box with code 0.

Rockers with illuminated windows (codes 20, 30, 60) : part numbers on request.

ROCKER MARKING

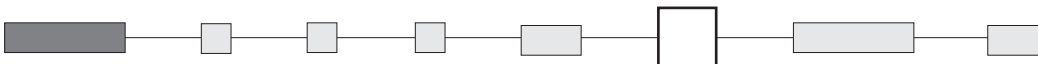

| MARKING \ COLOUR | - | 01 | 02 | 06 | 07 | 08 | 03 | 04 | 05* | 40 | 43* | 46 |
|------------------|----|----|----|----|----|----|----|----|-----|----|-----|----|
| Black | 00 | 01 | 02 | 06 | 07 | 08 | 03 | 04 | 05* | 40 | 43* | 46 |
| Red | 00 | 11 | 12 | 16 | 17 | 18 | 13 | 14 | 15* | 41 | 44* | 47 |
| White | 00 | 21 | 22 | 26 | 27 | 28 | 23 | 24 | 25* | 42 | 45* | 48 |

* Not available on V-shaped rockers

Special markings and marking on rockers with illuminated window : consult factory.

2600 series

Power rocker switches

OPTIONS
● ● ●

LAMP

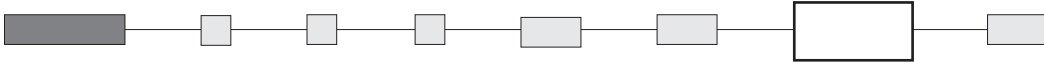

| | |
|--------|---|
| L0 | Non-illuminated switch |
| L6V | Filament lamp 6V |
| L12V | Filament lamp 12V |
| L24V | Filament lamp 24V |
| L110V | Neon lamp 110VAC |
| L110V1 | BLUE fluorescent lamp 110VAC |
| L110V3 | Green fluorescent lamp 110VAC |
| L220V | Neon lamp 220VAC |
| L220V1 | BLUE fluorescent lamp 220VAC |
| L220V3 | Green fluorescent lamp 220VAC |
| L380V | Neon lamp 380VAC |
| L380V1 | BLUE fluorescent lamp 380VAC |
| L380V3 | Green fluorescent lamp 380VAC |
| LI | EN61058-1 approved version without lamp (3 position switches) |

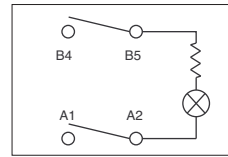

For illuminated models, the lamp is always connected between center terminals 2 and 5.



Lamps L380V, L380V1 and L380V3 are not UL/CSA approved.

ILLUMINATED WINDOW

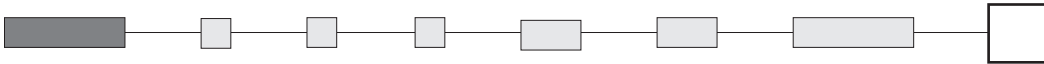

For black, green and red rockers only

/3 Green
/6 Red

With green, use fluorescent lamp only.
No marking available on illuminated windows.

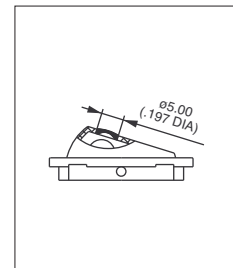

D